



WESTERN BLENDED PRODUCTS
The Plasterer's Standard

Systems: Western 1-Kote

A stucco system assembly for residential & commercial buildings with Insulated & Crack Resistant Systems (CRS) optional components.

Consult the latest Western 1-Kote Evaluation Report for all approved system components and available assemblies.

SYS Systems & Assemblies

System description:

Western 1-Kote Systems are complete stucco assemblies for residential and commercial buildings. All W1K Systems are code compliant stucco assemblies that may be installed over open framing or various approved sheathing surfaces. Some of these assemblies provide improved energy efficiency and higher R-Values when combined with an approved continuous insulation board component. W1K Systems are impact resistant, and may be installed as a conventional system coating (scratch & brown) complying with ASTM C926. Fire resistant assemblies are available. Consult the latest Western 1-Kote Evaluation Report for further details.

Systems Recognition:

Western 1-Kote Exterior Stucco Systems have been evaluated as an exterior wall covering in compliance with Chapters 14 and 25 of the IBC and Chapter 7 of the IRC.

System Components:

Western 1-Kote systems may consist of following components:

- **An approved substrate (or open framing).** Consult the latest Western 1-Kote Evaluation Report for approved substrate options.
- **A water-resistive barrier.** Weather-resistive barriers shall comply IBC with Sections 1404.2 and 2510.6, IRC Section R703.2" [AC11], or the ICC-ES Acceptance Criteria for Water-resistive Barriers (AC38).
- **A continuous Insulation Board (optional):**
 - **Foam Board:** (EPS) foam plastic insulation boards shall be Type II as set forth in ASTM C578, with a minimum nominal density of 1.5 pcf (24 kg/m³). Extruded polystyrene (XPS) foam plastic insulation boards shall be Type IV or Type V as set forth in ASTM C578, with a minimum nominal density of 1.5 pcf (24 kg/m³). Polyisocyanurate foam plastic insulation boards shall be Type II as set forth in ASTM C1289, with a minimum nominal density of 2.0 pcf (32 kg/m³).
 - **Mineral Wool Board:** Unfaced mineral wool insulation boards shall be Type IVA or IVB per ASTM C612, with a minimum thickness of 1 inch (25.4 mm), a minimum 8 pcf (128 kg/m³) density, qualified as non-combustible when tested to ASTM E136, and labeled in accordance with ESR-3773. ROCKWOOL Sheathed Assembly [Intertek Report Link](#). Open Framing [Intertek Report Link](#).
- **Woven Wire or Metal Lath.** Lath shall be regular or self-furring wire fabric lath or metal lath and "shall comply with the ICC-ES Acceptance Criteria for Metal Plaster Bases (Lath) (AC191).
- **A Western 1-Kote Cementitious Basecoat.** Available in a sanded presentation. When the Concentrated version is used, it shall be mixed with 250 Lbs of ASTM C144 or C897 graded aggregate.
- **A BPS Kote, Skim Coat with embedded fibermesh - Crack-Resistant System (CRS) (optional).** BPS Kote must be applied at a minimum thickness of 1/16" with an approved alkali-resistant reinforcing fibermesh fully embedded within the coating.
- **A PAF Primer Coat (optional).** PAF primer may be tinted to match the desired finish.
- **A Finish Coat.** Acceptable finishes for Western 1-Kote, and the products noted in the latest Western 1-Kote Evaluation Report include Western Blended Products (WBP), WBP Premium Acrylic Finishes (PAF), WBP Exterior Stucco Finishes, WBP Elastomeric Paints, and WBP PAF Specialty Products

System Overview:

Typically, Western 1-Kote systems are stucco assemblies in which the water resistive barrier is installed over open framing or an approved sheathing substrate. An optional EPS, XPS or Polyisocyanurate Foam Plastic Insulation Board or Mineral Wool Insulation Board is then attached over the previously installed water resistive barrier. Woven Wire or Metal Lath is fastened to the optional continuous insulation board. A basecoat of Western

1-Kote is then applied over the wire or lath, at a minimum thickness of 3/8". Western 1-Kote products are available in Concentrated and Sanded presentations. An optional Skim Coat of BPS Kote with embedded fibermesh may be applied over the Western 1-Kote basecoat as part of a Crack Resistant System (CRS). A variety of finish coats may be applied over the Western 1-Kote basecoat or Crack Resistant System. All Western Blended Products Exterior Stucco Finishes: Base A & B Stucco and Paint Base Exterior Stucco Finish, as well as all Premium Acrylic Finishes (PAF) and PAF Specialty Finishes are suitable exterior finish coats for all Western 1-Kote systems. Please consult **Table 1** in this document for all available options.

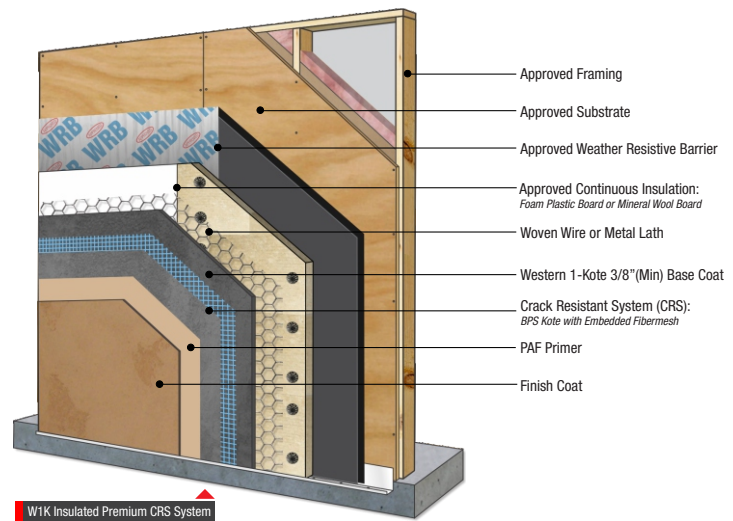

System Limitations and Requirements:

Ensure the following is taking place before the application of the system components:

- All components must be installed per code requirements.
- Wood-based sheathing shall be gapped 1/4" to allow for expansion.
- Substrates are structurally sound, free of loose materials, voids, projections or other conditions that may interfere with the installation of the components.
- Substrates are dry, clean, free of oils, grease, efflorescence, or other liquid or solid debris.
- There are no projections or planar irregularities greater than 1/4" within any 4' radius in the substrate.
- Masonry or Concrete surfaces are sealed or prepared with a bonding agent prior to the application of any basecoat.
- All penetrations & openings are properly flashed.
- All components are stored above ground under optimal conditions, or if stored outdoors, shall be adequately covered to keep dry.
- Components shall be installed as instructed by the manufacturer and must be in compliance with the latest Evaluation report and stated references (if applicable).
- Components shall not be installed when surface or ambient temperatures are at or below 40°F / 4.4°C or above 100°F / 34°C.
- Cementitious components require a minimum of forty-eight (48) hours moist curing. Environmental conditions such a heat, wind and low humidity will require additional curing.
- Protect all installed components from freezing and inclement weather until dry.
- Consult the latest existing codes & regulations prior to the installation of

Aug 2023

System: Western 1-Kote - Page 1

Sacramento Stucco Co.
1550 Parkway Blvd. West Sacramento, CA 95691 / (916) 372-7442
Western Stucco Co.
6101 N. 53rd. Drive Glendale, AZ 85311 / (623) 939-9455
Rio Grande Stucco Co.
9151 Roseway Drive El Paso, TX 79907 / (915) 858-3494

Visit us on the web:
westernblended.com



Western Blended Products are manufactured in the U.S.A. utilizing the strictest quality control processes to ensure consistent, high-performance products on every project.





WESTERN BLENDED PRODUCTS
The Plasterer's Standard

Systems: Western 1-Kote

A stucco system assembly for residential & commercial buildings with Insulated & Crack Resistant Systems (CRS) optional components.

Consult the latest Western1-Kote Evaluation Report for all approved system components and available assemblies.

SYS Systems & Assemblies

System Assembly Options and Warranties:

All available Western 1-Kote systems assemblies are listed in the following Table. System Warranties are different and dependant upon the selected assembly. Contact WBP for more information.

Table 1. Western 1-Kote System Components & Warranties.

Western 1 -Kote System	Components	Warranty.
W1K Standard	<ul style="list-style-type: none"> Insulation Board: None. Basecoat Admix: None. Basecoat: W1K Gray Concentrate. Crack Resistant System (CRS): None. Primer Coat: None. Finish Coat: Exterior Stucco Finish or Premium Acrylic Finish. 	3 Years.
W1K Insulated	<ul style="list-style-type: none"> Insulation Board: EPS / XPS / Mineral Wool Basecoat Admix: None. Basecoat: W1K Gray Concentrate. Crack Resistant System (CRS): None. Primer Coat: None. Finish Coat: Exterior Stucco Finish or Premium Acrylic Finish. 	3 Years.
W1K Standard SND	<ul style="list-style-type: none"> Insulation Board: None. Basecoat Admix: None. Basecoat: W1K Premium Sanded or Sanded Gray. Crack Resistant System (CRS): None. Primer Coat: None. Finish Coat: Exterior Stucco Finish or Premium Acrylic Finish. 	5 Years.
W1K Insulated SND	<ul style="list-style-type: none"> Insulation Board: EPS / XPS / Mineral Wool Basecoat Admix: None. Basecoat: W1K Premium Sanded or Sanded Gray. Crack Resistant System (CRS): None. Primer Coat: None. Finish Coat: Exterior Stucco Finish or Premium Acrylic Finish. 	5 Years.
W1K Standard SND - CRS	<ul style="list-style-type: none"> Insulation Board: None. Basecoat Admix: None. Basecoat: W1K Premium Sanded or Sanded Gray. Crack Resistant System (CRS): None Primer Coat: PAF Primer Finish Coat: Premium Acrylic Finish. 	7 Years.
W1K Insulated SND - CRS	<ul style="list-style-type: none"> Insulation Board: EPS / XPS / Mineral Wool Basecoat Admix: None. Basecoat: W1K Premium Sanded or Sanded Gray. Crack Resistant System (CRS): None Primer Coat: PAF Primer Finish Coat: Premium Acrylic Finish. 	7 Years.
W1K Standard Premium - CRS	<ul style="list-style-type: none"> Insulation Board: None. Basecoat Admix: Blackcap Admix (Optional) Basecoat: W1K Premium Sanded or Sanded Gray. Crack Resistant System (CRS): BPS Kote with embedded fibermesh (Optional) Primer Coat: PAF Primer. Finish Coat: Premium Acrylic Finish Plus, e2 or PAF Specialty Finishes. 	10 Years. (+5 Years w/ CRS System)
W1K Insulated Premium - CRS	<ul style="list-style-type: none"> Insulation Board: EPS / XPS / Mineral Wool Basecoat Admix: Blackcap Admix (Optional) Basecoat: W1K Premium Sanded or Sanded Gray. Crack Resistant System (CRS): BPS Kote with embedded fibermesh (Optional) Primer Coat: PAF Primer. Finish Coat: Premium Acrylic Finish Plus, e2 or PAF Specialty Finishes. 	10 Years. (+5 Years w/ CRS System)

Warranty:

Manufacturers or Western Blended Products (WBP) warrants its products to be of merchantable quality and suitable for the general purpose for which they were intended, when applied in accordance with WBP instructions. Manufacturers of WBP do not warrant its products to be suitable for any purpose or use other than for which they were intended. Liability under this warranty is limited to supplying new material without charge, or at manufacturers of WBP option, to a refund of the purchase price. In the event of a claim under this warranty, written notice must be given to the originating plant of the WBP goods at the address shown hereon. This limited warranty is issued and accepted in lieu of all other expressed warranties, and expressly excludes liability for consequential damages. Some states do not allow the exclusion or limitation of incidental or consequential damages, or limitations on how long an implied warranty lasts, so the above limitations and exclusions may not apply to you. This warranty gives you specific legal rights, and you may also have other rights that vary from state to state.

Aug 2023

System: Western 1-Kote - Page 2

Sacramento Stucco Co.
1550 Parkway Blvd. West Sacramento, CA 95691 / (916) 372-7442
Western Stucco Co.
6101 N. 53rd. Drive Glendale, AZ 85311 / (623) 939-9455
Rio Grande Stucco Co.
9151 Roseway Drive El Paso, TX 79907 / (915) 858-3494

Visit us on the web:
westernblended.com



Western Blended Products are manufactured in the U.S.A. utilizing the strictest quality control processes to ensure consistent, high-performance products on every project.

